

# Model TS16 Square Flange Style Reaction Torque Transducer

Why the Interface model TS16 Square Flange Style Reaction Torque Transducer is the best in class:

- Capacities from 2 to 2K Nm (17.7 to 17.7K lbf-in)
- Convenient flange mounting
- Accepts standard sockets



TS16 Square Flange Style Reaction Torque Transducer

## OPTIONS

100 % Control Signal (RCAL)  
 Combined Error 0.1% FS

## SPECIFICATIONS

### ACCURACY – (MAX ERROR)

Combined Error-% FS .....±0.2  
 Nonrepeatability-% .....±0.02

### TEMPERATURE

Effect on Zero-% RO/°C .....±0.02  
 Effect on Output-%/°C .....±0.01  
 Rated Range-°C .....-5 to +45  
 Operating Range-°C .....-15 to +55

### ELECTRICAL

Output-mV/V .....1  
 Excitation Voltage-VDC MAX .....12  
 Bridge Resistance-Ohm .....350  
 Electrical Connection .....6-pin binder

### MECHANICAL

Safe Overload-% RO .....150  
 Angular Deflection @ Rated Torque° .....<0.2  
 Cyclic Load Rating-% RO .....±70 peak

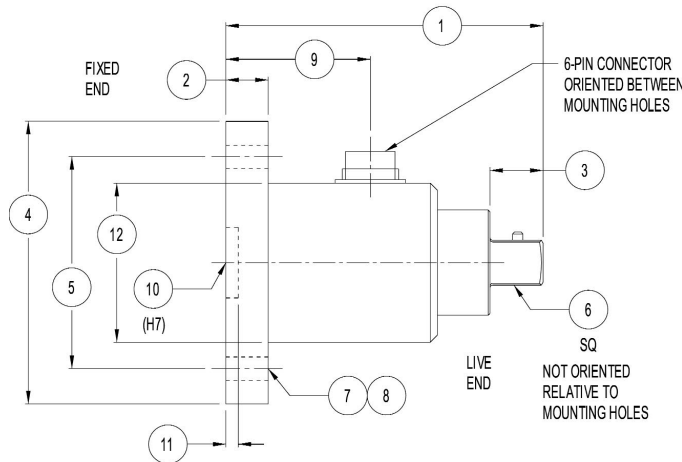

TS16 Square Flange Style Reaction Torque Transducer - Capacities 2 to 2,000 Nm

## DIMENSIONS

Nominal Torque												
Capacity (Nm)	2, 5, 12		25, 63		160		500		1K		2K	
Equivalent (lb-in)	17.7, 44.3, 106		221, 1K		1.41K		4.43K		8.85K		17.7K	
	inch	mm	inch	mm	inch	mm	inch	mm	inch	mm	inch	mm
①	2.76	70	2.76	70	3.54	90	4.72	120	5.51	140	7.09	180
②	0.39	10	0.39	10	0.47	12	0.59	15	0.59	15	0.79	20
③	0.28	7.2	0.41	10.4	0.59	15.1	0.89	22.6	1.08	27.4	1.55	39.3
④	2.76	70	2.76	70	3.15	80	3.94	100	4.72	120	5.71	145
⑤	1.97	50	1.97	50	2.36	60	3.15	80	3.94	100	4.72	120
⑥	1/4"	6.35	3/8"	9.53	1/2"	12.7	3/4"	19.05	1"	25.4	1 1/2"	38.1
⑦	4x90°		4x90°		4x90°		6x60°		8x45°		8x45°	
⑧	0.22	5.5	0.22	5.5	0.26	6.6	0.35	9	0.43	11	0.51	13
⑨	1.42	36	1.42	36	1.61	41	2.36	60	2.76	70	3.23	82
⑩	1.53	39	1.57	40	1.77	45	1.93	49	2.32	59	2.76	70
⑪	0.12	3	0.12	3	0.12	3	0.12	3	0.12	3	0.12	3